

SR02 Sealed Rivet

Dome head · Aluminium body · Stainless steel stem · Sealed
3.2 mm (1/8") - 4.8 mm (3/16")

Features

- Fully sealed and weather proof, sealed against moisture air and other contaminants
- Good hole fill and retained stem provide strong vibration resistant joints
- Higher tensile and shear strength than equivalent open end rivets

Material

- Body: Aluminium alloy (AlMg5), polished
- Stem: Stainless steel 304, polished

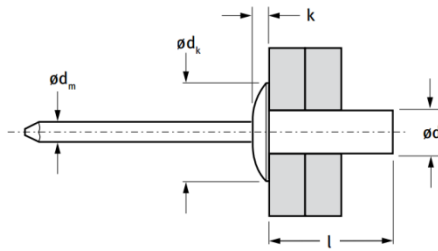

Before Placement

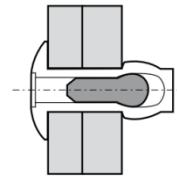

After Placement

Part No.	Size ø	Grip Range		Hole Size	ød	l	ødk	k	ødm	Shear (typical) kN	Tension (typical) kN
		min.	max.								
OSR02-03265	3.2 (1/8")	0.5	2.0	3.3	3.2	6.5	6.0 [±0.24]	1.4	1.7	1.07	1.25
OSR02-03280		2.0	3.5			8.0					
OSR02-03295		3.5	5.0			9.5					
OSR02-03211		5.0	6.5			11.0					
OSR02-03212		6.5	8.0			12.7					
OSR02-04080	4.0 (5/32")	0.5	3.5	4.1	4.0	8.0	8.0 [±0.29]	1.7	2.18	1.70	2.24
OSR02-04095		3.5	4.5			9.5					
OSR02-04011		4.5	6.5			11.0					
OSR02-04012		6.5	8.0			12.7					
OSR02-04880	4.8 (3/16")	1.0	3.0	4.9	4.8	8.0	9.5 [±0.29]	2.0	2.63	2.20	3.10
OSR02-04895		3.0	4.5			9.5					
OSR02-04811		4.5	6.0			11.0					
OSR02-04812		6.0	7.5			12.5					
OSR02-04814		7.5	9.0			14.0					
OSR02-04816		9.0	11.0			16.0					
OSR02-04818		11.0	13.0			18.0					
OSR02-04821		13.0	16.0			21.0					